



# Splitter Box Flow Control Tank

Kent Stainless manufactured this Splitter Box Tank for a Pharmaceutical Wastewater Treatment Plant in a Pharmaceutical Factory in 2016.

This tank receives the wastewater from the process waste Tank seen earlier in this brochure. It contained 8 adjustable weir gates to control the flow.

The tank measures 3112mm long x 2250mm wide x 1950mm high (123in x 89in x 77in) and weighs 5,700kg empty. The sump is made from 6mm thick grade 316L stainless steel and has a 2,600 litre working capacity (686 US Gallons).

The overall footprint including stand and handrails is 3112mm long x 2250mm wide x 5517mm high (123in x 89in x 217in).

- INDUSTRIES**
- BioPharma
  - Food & Beverage
  - Pharmaceutical
  - Wastewater

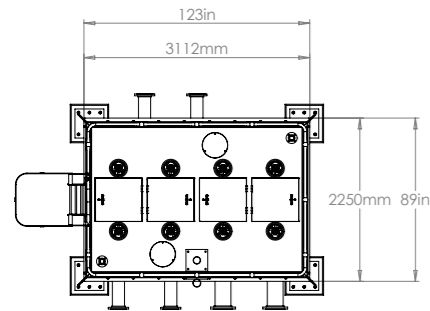
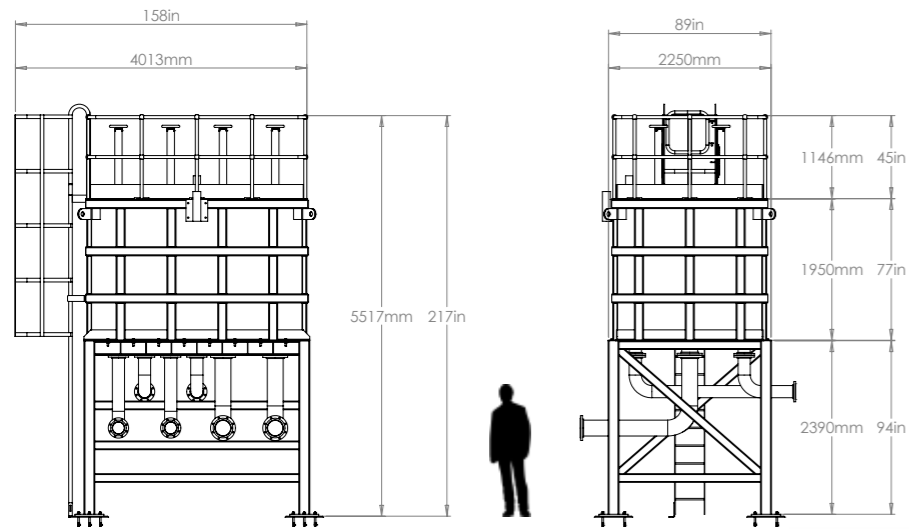

**Adjustable Weirs** with non floor stands and hand wheels - 8nr

**Outlets - Raised face Slip On Flanges - 6nr**

Height	Width	Length	Weight	Volume
1950mm	2250mm	3112mm	5,700 kg	2,600 L
77in	89in	123in	12,566 lb	686 Gallon



**Non Rising Floor Stands and Hand Wheels - 8nr**



**Kick Plate All Round plus handrail**



**Hinged Access Covers 600mm - 4nr**



**Inlets - Raised face Slip On Flanges - 2nr**

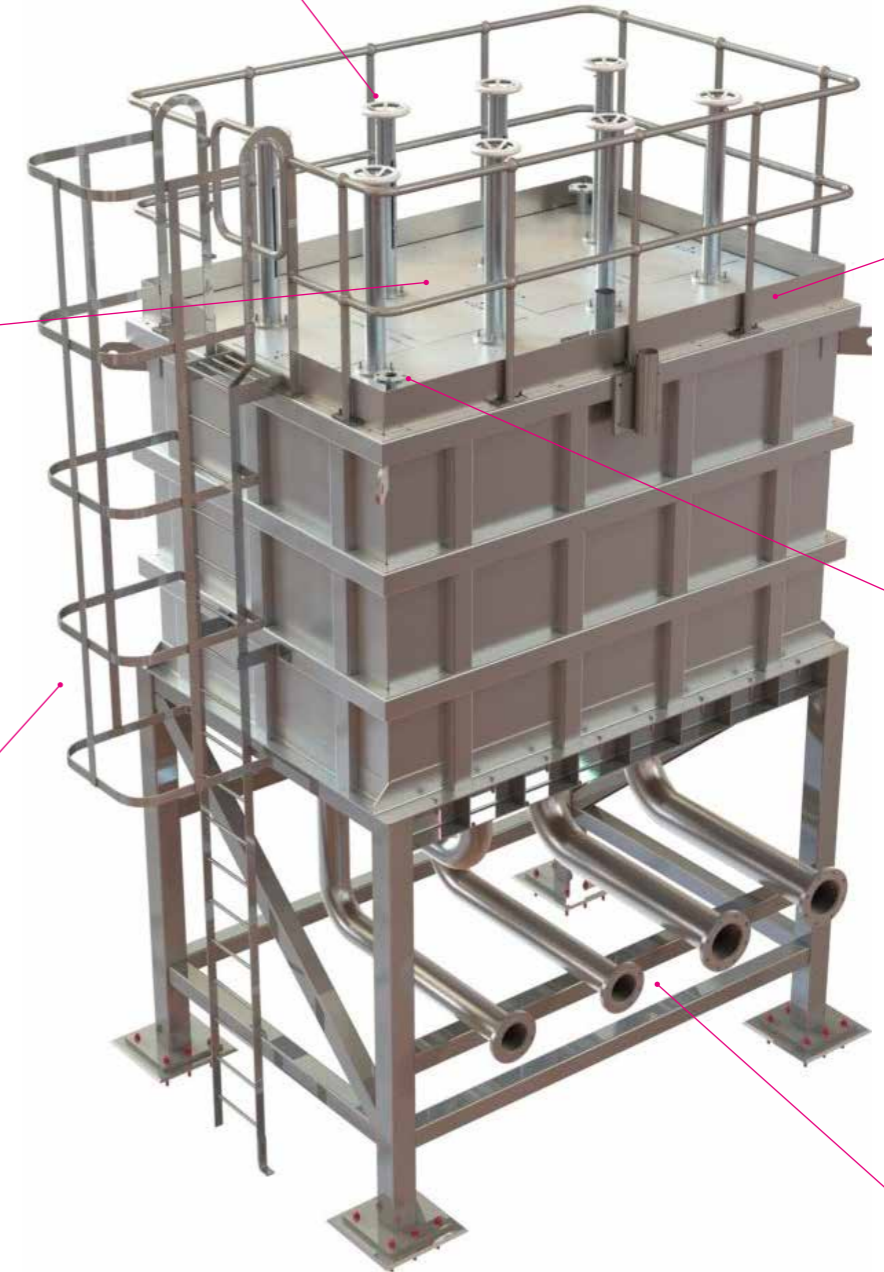

**Ladder with Safety Cage & Spring Loaded Gate**



**Inlets - Raised face Slip On Flanges - 6nr**